

AKASO

EK7000

ACTION CAMERA



USER MANUAL

8328-USB-C

Content

Important Messages-----	01	>>
Notes on Using the Waterproof Housing-----	02	>>
What's in the Box -----	03	>>
Your EK7000 -----	04	>>
Getting Started-----	05	>>
Overview of Modes-----	08	>>
Customizing Your EK7000-----	10	>>
Using the Camera's Wifi & AKASO GO App-----	15	>>
Playing Back Your Content-----	23	>>
Data Transmission-----	23	>>
Maintaining Your Camera-----	24	>>
Maximizing Battery Life-----	24	>>
Battery Storage and Operation -----	25	>>
Remote -----	26	>>
Mounting Your Camera-----	29	>>
Contact Us-----	30	>>

To get detailed instructions on operating this camera, watch how-to videos by scanning the provided QR code or visiting this link: <https://www.akasotech.com/videos>.



Important Messages

Congratulations on your new AKASO EK7000 Action Camera! You must be excited to use your new camera, but please spend some time familiarizing yourself with this manual first so that you get the most out of your camera's features and use it safely. It's important to regularly update the camera's firmware. Connect your camera to the AKASO GO app through the camera's Wifi to download and install the latest firmware.

1. This camera is a precision instrument. Safeguard it from drops or impacts to prevent damage.
2. Ensure the camera operates within its recommended temperature range. Avoid leaving it at high or low temperatures for extended periods, as this can reduce its lifespan.
3. This camera body is waterproof, but make sure all covers are tightly closed and the lens area is free from debris before immersing it underwater.
4. After using the camera in saltwater, rinse it with fresh water and gently dry it with a soft cloth.
5. Avoid charging the camera for long periods of time. While charging, keep the camera away from kids and pets to prevent accidents.
6. Remove the battery from the camera if you don't plan to use it for an extended period.
7. Store the camera away from devices or objects with strong magnetic fields or power, like motors and magnets.
8. Store the camera away from sharp objects and moisture-prone areas.



Notes on Using the Waterproof Housing

This camera is not waterproof, so it's essential to place it in the included waterproof housing before using it in wet or underwater environments. The housing protects your camera from mud, dirt, debris, and, most importantly, water during your adventures. With the camera properly secured inside, you can safely dive up to 40 meters (132 feet) without concern.

To maximize the potential of the waterproof case, follow these guidelines:

Before Use

1. Carefully inspect the housing for any signs of wear, cracks, or damage. Replace or repair it immediately if needed to ensure proper protection.
2. Check that all buttons on the housing function correctly and examine the rubber seal for any damage or deformities that could cause leaks.
3. Clean the camera's surface thoroughly to remove dust, dirt, or oil that could compromise the waterproof seal.
4. Once the camera is inside the housing, ensure no foreign objects are trapped around the rubber seal, and firmly close the backdoor to create a secure, watertight seal.

During Use

1. Avoid prolonged submersion to minimize potential stress on the housing and internal components.
2. Do not exceed the maximum depth rating, as excessive pressure could cause leaks or cracks, endangering your camera.

After Use

1. Rinse the housing thoroughly with fresh water after each use to remove salt, chlorine, or debris, then dry it completely to prevent stains or residue buildup.
2. Submerge the housing in clean water for 5–10 minutes, gently shaking it to help dislodge any trapped residue.
3. Clean and dry both the interior and exterior with a soft cloth, then leave it in a well-ventilated area to air dry completely before storing it.



What's in the Box



AKASO EK7000
x 1



Waterproof
Housing x 1



Battery Charger
x 1



Battery
x 2



USB Cable
x 1



Remote Control
x 1



Remote Control
Strap x 1



Protective
Backdoor x 1



Clip
x 1



Clip 2
x 1



Buckle Mount
x 1



J-Hook Mount
x 1



E Mount
x 1



C Mount
x 1



D Mount
x 1



F Mount
x 1



A Mount
x 1



H Mount
x 1



Helmet Mount
x 2



Spanner
x 1



Bandage
x 4



Tether
x 5



Lens Cloth
x 1



Double Sided
Adhesive Tape x 2



Quick Start
Guide x 1



Your EK7000

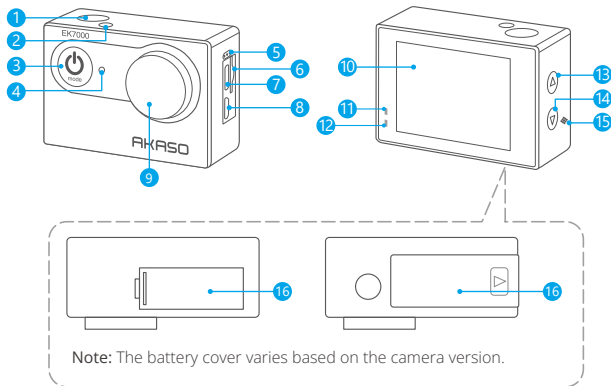

- | | |
|------------------------------|----------------------|
| ① Shutter / OK Button | ⑨ Lens |
| ② Working / Wifi Indicator | ⑩ Display Screen |
| ③ Power / Mode / Exit Button | ⑪ Charging Indicator |
| ④ Charging Indicator | ⑫ Working Indicator |
| ⑤ Microphone | ⑬ Up Button |
| ⑥ Memory Card Slot | ⑭ Down / Wifi Button |
| ⑦ USB / External Mic Port | ⑮ Speaker |
| ⑧ HDMI Port | ⑯ Battery Cover |

Note: The camera does not record sound when it is in the waterproof case.



Getting Started

Welcome to your new EK7000. To capture video and photos, you will need a memory card (sold separately).

Using Memory Cards

Use brand name memory cards that meet these requirements:

- Class 10 or UHS-I rating.
- Capacity up to 256GB (FAT32).

Note:

- The FAT32 format memory card stops recording when the storage of each file exceeds 4GB and starts to record on a new file.
- Memory cards larger than the specified maximum capacity can cause issues like non-recognition or even camera malfunctions like unresponsiveness or firmware failure.

Installing the Memory Card

First locate the memory card slot, then insert the memory card in the direction indicated by the figure. To remove the card, simply press it into the slot with your fingernail, and it will then pop out.

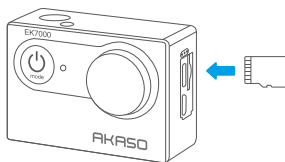

Note: Be sure to turn off the camera before installation.

Formatting the Memory Card

Before using, please format the memory card in the camera. To keep your memory card in good condition, reformat it on a regular basis. Reformatting deletes all of



your data, so be sure to transfer your photos and videos first.

1. When on the preview screen, press the Mode button seven times to access system settings, and press the Down button till you locate the "Format" option.
2. Press the Shutter button and select the "Yes" option.
3. Press the Shutter button again to confirm formatting.
4. Wait a few seconds, and the card is formatted successfully.

Installing the Battery

Open the buckle of the battery cover, then place the battery into its slot and close the battery cover. To remove the battery, pull the battery strip.

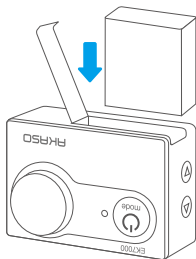
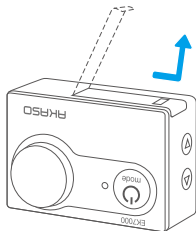

Charging the Camera

Locate the USB power port, and connect the camera to a USB adapter or computer using the included USB cable. The charging indicator remains red while charging, and blacks out when fully charged. Once fully charged, disconnect the cable.

Tip: Please fully charge the camera before first use, you can also charge the battery separately using the included battery charger; you can get up to 90 minutes of runtime in 4K30 with Image Stabilization off and Screen Saver on.

Powering on or off

To power on: While the camera is off, press and hold the Power button for 3 seconds to turn it on. Once the display screen shows camera information and the working indicator turns on, you'll know that your camera is powered on.

To power off: While the camera is on, press and hold the Power button for 3 seconds to turn it off. The working indicator will also turn off.

Turning Wifi on or off

To turn on: On the preview screen, press the Down / Wifi button to turn on Wifi.

To turn off: On the Wifi screen, press the Down / Wifi button to turn off Wifi.

Tip: You cannot operate the camera in Wifi mode; if the camera's Wifi is activated but not linked to the app within 3 minutes, it will auto-disable. Re-activate the camera's Wifi to reconnect to the app.

Turn Audio Recording on or off

On the preview screen, press the Up button to turn the audio recording feature on or off.

Switching Modes

To switch mode: On the preview screen, press the Mode button to switch modes among Video, Photo, Video Playback, Photo Playback, Video Settings, Photo Settings, General Settings, and System Settings.

To exit mode: Press the Mode button to exit the current mode. On the system Settings screen, press the Mode button to return to the preview screen.

Zooming in or out

On the preview screen, press and hold the Up or Down button to zoom in or out. The EK7000 action camera supports up to 4x zoom.

Note: The zoom feature is available only in Photo Mode, and when taking photos in resolutions of 12MP or lower.

Using the Shutter Button

In Photo or Video mode, press the Shutter button to capture photos or start video recording. To stop recording in Video mode, press the Shutter button again.

Overview of Modes

The camera boasts 8 modes: Video, Photo, Video Playback, Photo Playback, Video Settings, Photo Settings, General Settings and System Settings.

On the preview screen, press the Mode button to switch modes.

Video Mode

The camera is in Video Mode by default when turned on. In this mode, press the Shutter button to start recording videos. To stop recording, press the Shutter button again.

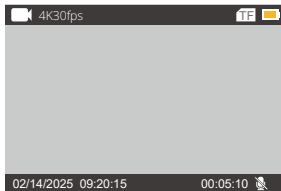

Photo Mode

On the preview screen, press the Mode button once to switch to Photo Mode. In this mode, press the Shutter button to take a photo at the preset photo resolution.



Video Playback Mode

On the preview screen, press the Mode button twice to switch to Video Playback Mode. In this mode, press the Up or Down button to choose the video you want to playback, and press the Shutter button to open it in full-screen view. The selected video will then play.

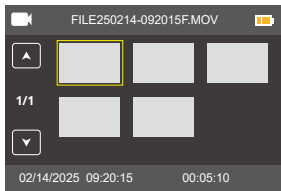
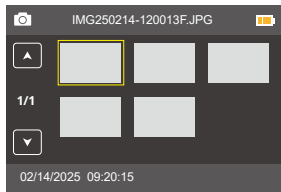

Photo Playback Mode

On the preview screen, press the Mode button 3 times to switch to Photo Playback Mode. In this mode, press the Up or Down button to choose the photo you want to playback, and press the Shutter button to open it in full-screen view.



Video Settings Mode

On the preview screen, press the Mode Settings Mode button 4 times to switch to Video.

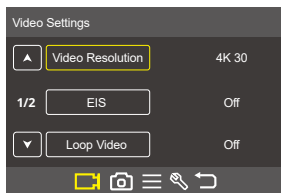
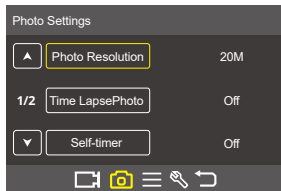

Photo Settings Mode

On the preview screen, press the Mode button 5 times to switch to Photo Setting Mode.



General Settings Mode

On the preview screen, press the Mode button 6 times to switch to General Settings Mode.

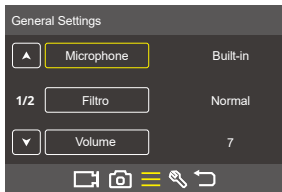

System Settings Mode

On the preview screen, press the Mode button 7 times to switch to System Settings Mode.

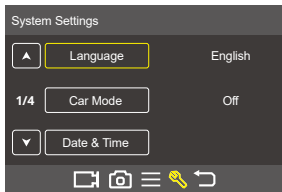

Customizing Your EK7000

Video Settings

1. Video Resolution

4K 30fps / EIS 4K 30fps / 2.7K 30fps / 1080P 60fps / 1080P 30fps / 720P120fps / 720P 60fps (Default setting: 4K/30fps)

Configure the resolution settings before recording videos. The camera records up to 4K 30fps videos.

Note: Capturing videos in warm environments in high resolutions and frame rates will consume more power; the video resolution is automatically set to EIS 4K30 when EIS is enabled.



2. EIS (Image Stabilization)

Off / On (Default setting: Off)

Electronic Image Stabilization can efficiently smooth out the lens shakes, resulting in smooth and clear videos. This feature is ideal for capturing scenes involving activities like riding, skating, and handheld use.

3. Loop Video

Off / 1Min. / 3 Min. / 5 Min. (Default setting: Off)

Set the loop duration for the camera to capture short video clips. For instance, if you set "Loop Video" to "3 Min.", the camera will save video files every 3 minutes. When the memory is full, new video files will overwrite the old ones to ensure continuous recording.

4. Time Lapse Video

Off / 1 Sec. / 3 Sec. / 5 Sec. / 10 Sec. / 20 Sec. / 30 Sec. / 60 Sec. (Default setting: Off.)

Specify the frequency at which the video frames are captured and compiled. With this setting enabled in Video Mode, the camera captures a series of frames at the set interval and condenses them into a short video clip, making it ideal for use in capturing dynamic or changing scenes, such as clouds, stars, sunsets, and more.

Note: Time Lapse Video is captured without audio.

Photo Settings

1. Photo Resolution

20MP / 16MP / 14MP / 12MP / 8MP / 5MP / 4MP (Default setting: 20MP)

Set the photo resolution before capturing photos. This camera is capable of capturing 20MP photos, with higher resolution offering greater clarity and detail due to the increased number of pixels. However, higher resolution photos also result in larger file sizes.

2. Time Lapse Photo

Off / 1 Sec. / 3 Sec. / 5 Sec. / 10 Sec. / 30 Sec. / 60 Sec. (Default setting: Off)

Set the interval at which the camera takes a photo in Photo mode. For instance, if you select the "3 Sec." option, the camera will start counting down from 3 and take a photo. This process repeats continuously until you press the Shutter button again.

3. Self-Timer

Off / 2 Sec. / 5 Sec. / 10 Sec. (Default setting: Off)

Set the countdown time before the camera takes a photo. For instance, if you select the "2s" option, the camera will initiate a 2-second countdown, then automatically activate the shutter to capture a photo.

4. Burst Photo

Off / 3 Photos / 5 Photos (Default setting: Off)

Set the number of photos to be taken per second. The camera will take photos at the set shot.

General Settings

1. Microphone

Built-in / External (Default setting: Built-in)

Choose to select either a built-in microphone or an external one. To use an external microphone for better sound quality, select the "External" option first. Then, connect a compatible external microphone to the camera's USB port.

Tip: If you do not wish to use an external microphone, be sure to select the "Built-in" in case the camera does not properly record sound during video recording.

2. Filter

Normal / Black & White / Retro / Negative / Warm / Cool / Red / Green / Blue
(Default setting: Normal)

Choose an ideal filter for your photos or videos to enhance their appeal.

3. Volume

0-10 (Default setting: 7)

Adjust the camera's volume to an acceptable level.

4. Beep

On / Off (Default setting: On)

Set the volume of your EK7000's alerts.

5. Exposure

2 / 1.7 / 1.3 / 1 / 0.7 / 0.3 / 0 / -0.3 / -0.7 / -1 / -1.3 / -1.7 / -2 (Default setting: 0)

EV (Exposure Value) lets you adjust the brightness of your photos and videos. A higher EV value creates a brighter image, while a lower value results in a darker image.

6. Remote Control

Off / On (Default setting: On)

With this setting enabled, you can remote control to your EK 7000 with the included remote.

System Settings

1. Language

English / Español / Deutsch / Italiano/ Français / Português/ Русский / Latviešu / Polski / Українська / Čeština / România / Slovenski / 한국인 / Český / 简体中文 / 繁體中文 / 日本語 (Default setting: English)

Set the system language that appears on the camera.

2. Car Mode

On / Off (Default setting: Off)

When the camera is connected to a power source with this feature enabled in Video Mode, it will automatically power on and start recording. Upon disconnection from power, the camera will shut down and save the recorded footage. If the SD card reaches full capacity, the camera will automatically delete the oldest recordings to maintain continuous recording.

Note: This feature is only available in Video Mode; to ensure proper functionality, avoid using the camera in environments exceeding 45°C, such as inside a vehicle without air conditioning during summer.

3. Date & Time

Manually set your camera's date and time. The camera's date and time will sync with your phone when it's connected to the AKASO GO app.

4. Date Format

YYYY MM DD, MM DD YYYY, DD MM YYYY (Default setting: MM DD YYYY)

Set the date format for your camera based to your preferences.

5. Stamp

Off / On (Default setting: On)

With this setting enabled, the camera will add a watermark to the video or photo.

6. Frequency

50 Hz / 60 Hz (Default setting: 60 Hz)

Select the frequency for which the video recorded or played back on the TV according to your region. If you live in the northeastern area, please set the power frequency to 60Hz. If you live outside this area, set it to 50Hz. Be sure to select the correct format to avoid the light waves while capturing indoors.

7. Upside Down

On / Off (Default setting: Off)

This setting determines the orientation of your video or photos to help you prevent upside down footage.

Note: The user interface will be upside-down when Upside Down is enabled.

8. Screen Saver

Off / 30 Sec. / 1 Min. / 3 Min. (Default setting: 1 Min.)

Determine when the camera's display should go dormant to conserve battery. If you need the screen back on, just tap it or press any button.

9. Power Off

Off / 1 Min. / 3 Min. / 5 Min. (Default setting: 3 Min.)

Set the duration of inactivity after which the camera automatically powers off. If not operated within the chosen duration, the camera will shut down.

10. Format

Yes / No (Default setting: No)

To keep your microSD card in good condition, reformat it on a regular basis. Reformatting erases all of your content, so be sure to offload your photos and videos first.

11. Reset

Yes / No (Default setting: No)

This option resets all settings to their default values.

12. About

Brand: AKASO

Model: EK7000

Version: DLC7789IPS135V1

Updated Time: xxxxxxxx

Check the brand, model, version and updated time of your EK7000.

Using the Camera's Wifi & AKASO GO App

(1) Features of the Camera's Wifi

The camera Wifi works to connect the camera to the AKASO GO app to preview or transfer files.

Note: The camera's Wifi will not be connected to the internet. Disconnect it to restore internet access.

(2) Features of the AKASO GO App

- ① View the camera's status on your phone.
- ② Remotely control the camera with your phone.
- ③ Preview videos and photos stored on the SD card.
- ④ Download or edit videos or photos captured by your camera.
- ⑤ Update the camera's firmware.

Tips:

- ① Ensure the camera's Wifi is active before connecting to the AKASO GO app.
- ② The camera cannot be operated in Wifi mode. Exiting the Wifi screen disconnects the camera Wifi automatically.

(3) Downloading the AKASO GO App

- ① To sync your camera with the app, download the AKASO GO app from the App Store (iOS) or Google Play (Android) by searching for "AKASO GO". Alternatively, use the provided QR code:



AKASO GO



Android



iOS

- ② Access all app features by registering and logging into your AKASO GO account.



(4) Creating An Account for the AKASO GO App

- ① Open the AKASO GO app, then tap “My” in the bottom right corner to enter the registration page.

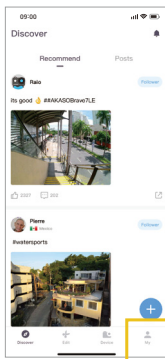

- ② Tap “Join Now” to enter the required information for login, then tap the “Log in” option. Now you successfully create the app account.

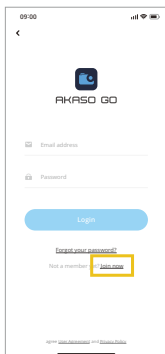

(5) Connecting to the AKASO GO App via Wifi

Please follow the steps below to connect your camera to the AKASO GO app.

Note: For a successful connection, first allow the app to access your Location and Local Network.

Step 1: Turn on your camera, press the Down / Wifi button to turn on Wifi.

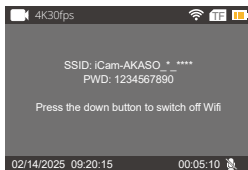

Step 2: Enter your phone's Wifi settings page, find the camera's Wifi named "ICAM-AKASO_****" in the list and tap on it, then enter the password 1234567890 to connect the device's Wifi.

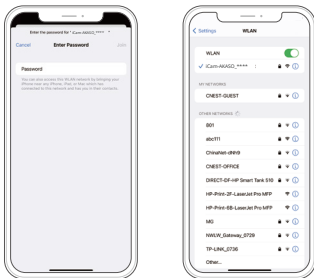

Step 3: Open the AKASO GO app, tap "Device"—> "Add Device", then select "EK7000" for connection.

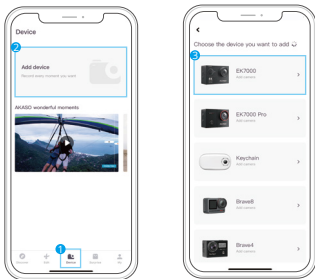

Step 4: Tick "The above operation has been confirmed", and tap "Live Preview". Your camera will be connected to the AKASO GO app in seconds.

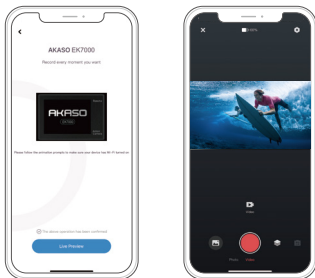

Tips:

- ① If you failed to connect the camera's Wifi, please make sure you successfully turned on the camera's Wifi. Please tap the "Research" option if you can't find the camera's Wifi.
- ② While connecting the camera's Wifi, a "No Internet Connection" or "Weak Security" notification will appear since the phone's data is paused.
- ③ The screenshots and steps above are for your reference only.

(6) AKASO GO App Introduction

A. User Interface

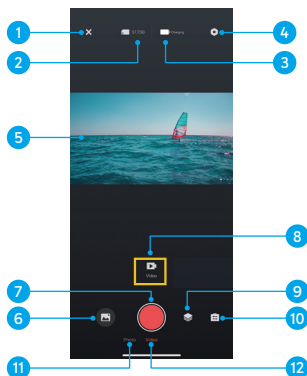

- 1 Disconnect from the app
- 2 Remaining Card Capacity
- 3 Battery Status
- 4 System Settings
- 5 Live Feed
- 6 Album Access
- 7 Shutter
- 8 Modes Available
- 9 Video/Photo Settings
- 10 Angle Settings
- 11 Photo Modes
- 12 Video Modes

B. Album

① Accessing the Album

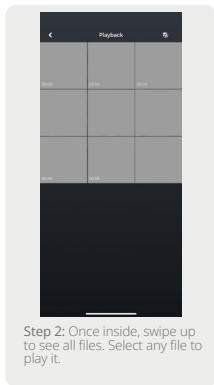
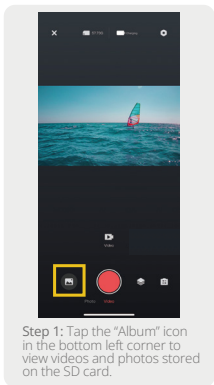

Tip: To access files captured by the camera, first allow the app to access your phone's album in Setting → AKASO GO → Photos → All Photos.

② Downloading Files to Your Phone

You can download video or photo files stored in the memory card via the AKASO GO app.

Follow the steps below to download files from the app to your phone.

Step 1: Access the album and tap the "Select" icon in the upper right corner.

Step 2: Select the file you want to download.

Step 3: Tap the "Download" icon in the bottom right corner and confirm the download.

Step 4: The file will be saved to your phone's gallery once the download completes.

Note: Do not alter Wifi settings or disconnect from the app during download. If you're using an iPhone, you cannot download 4K, 2.7K, and 1080P60 videos via the app. Please transfer these videos to your computer.

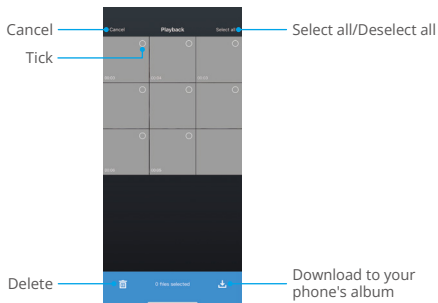

③ Delete Files on the App

Follow the steps below to delete files on the app.

Step 1: Access the album and tap the "Select" icon in the upper right corner.

Step 2: Select the file you want to delete.

Step 3: Tap the "Delete" icon in the bottom left corner and confirm the deletion.

Step 4: The selected file is now deleted.

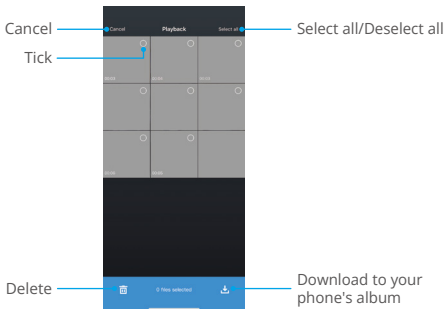

Note: Do not alter Wifi settings or disconnect from the app during deletion.

C. System Settings

Accessing System Settings Screen

Tap the Settings icon  in the upper right corner to access the AKASO GO app's settings screen.

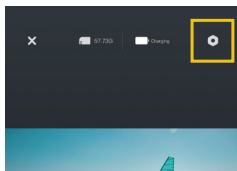

System Settings Menu

You can configure photo, video, and system settings within the System Settings screen. For more details about these settings, please refer to sections **Video & Photo Settings** and **System Settings**.

Playing Back Your Content

You can play back your content on the camera, your computer, TV, smartphone or tablet. You can also play back content by inserting the memory card directly into a device, such as a computer or a compatible TV. With this method, playback resolution depends on the resolution of the device and its ability to play back that resolution.

Viewing Your Videos or Photos on the EK7000

1. Enter Video or Photo Playback mode.

Note: If your memory card contains a lot of content, it might take a minute for it to load.

2. Press the Up or Down button to select the video or photo file you want to playback.
3. Press the Shutter button to open the file in full-screen view. The selected file will then play.

Tip: To delete the file, press and hold the Up button for 3 seconds and select the "Yes" option.

4. To return to the thumbnails screen, press the Mode button.
5. To exit the album, press the Mode button again.

Data Transmission

To playback or edit your files on the computer, you will need to first transfer them. You can transfer them in the following two methods.

Method 1: Transferring files via a card reader.

- ① Ensure the camera is turned off, then carefully remove the SD card.
- ② Insert the SD card into a card reader.
- ③ Connect the card reader to your computer's USB port.
- ④ Copy files to your computer for playback or editing.



Method 2: Transferring files via a data cable.

- ① Connect your camera to the computer using a USB data cable.
- ② When prompted, select “USB Storage” as your connection preference. You’ll be notified that your camera is now connected to the computer.
- ③ Navigate to the memory card drive on your computer, then transfer files as desired for playback or editing.

Note: Ensure you’re using a USB data cable, not just a charging cable, to enable data transfer.

Maintaining Your Camera

Follow these guidelines to get the best performance from your camera:

1. For optimal audio performance, gently shake the camera or blow on the microphone to remove any debris from the microphone holes.
2. To clean the lens, use a soft, lint-free cloth to wipe it. Avoid inserting any foreign objects near the lens.
3. Do not touch the lens with your fingers.
4. Keep the camera away from high temperatures and direct sunlight to prevent damage.

Maximizing Battery Life

A message appears on the display screen if the battery drops below 10%. If the battery reaches 0% while recording, the camera saves the file and powers off. To maximize battery life, follow these guidelines when possible:



- Turn off wireless connections.
- Capture video at lower frame rates and resolutions.
- Use the Screen Saver setting.

Battery Storage and Operation

1. If storing for extended periods, maintain a battery charge of 50-60%. Charge every 3 months and discharge the battery every 6 months.
2. Do not store the battery with metal objects such as coins, keys, or necklaces. If the battery terminals come close to metal objects, a short circuit may cause fire.
3. Store the battery in dry areas, safe from potential physical damage caused by squeezing or collision.
4. Avoid using or storing the battery at high temperatures, such as in direct sunlight or a hot compartment. The battery will heat up, malfunction, or have its service life shortened in these conditions.
5. Avoid using or storing the battery in low-temperature environments, as this will shorten the battery life or cause it to malfunction.
6. Avoid environments with strong static or magnetic fields; these can compromise the battery's protective unit, posing safety risks.
7. If the battery emits an odor, overheats, changes color, gets distorted, or exhibits any anomalies, discontinue use and remove it immediately from the camera or the battery charger whether it is being used, charged, or stored.
8. Safely insulate used electrodes to prevent potential hazards.



Remote

When the camera is turned on with the Remote Control setting enabled, it will be automatically connected to the remote within a certain distance. You can control the camera to take photos or record videos using the remote.

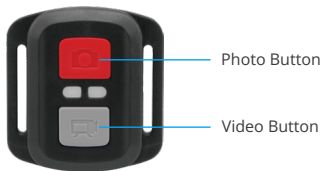

Note: The remote is splash-proof only.

Video

To record video, first make sure the camera is in Video mode, then press the Video button. The camera's working indicator will be flashing during video recording. To stop recording, press the Video button again.

Photo

To capture a photo, first make sure the camera is in Photo mode, then press the Photo button. The camera will emit a shutter sound indicating the completion of the shot.

Burst Photo

To capture burst photos, first verify the camera is in Burst Photo mode, then press the Photo button. The camera will emit a shutter sound indicating the completion of the shot.

Time Lapse

To capture time lapse photos or videos, first verify the camera is in Time Lapse mode, then press the Photo or Video button. The camera will emit a shutter sound indicating the completion of the shot.



Replacing the CR2032 battery of the remote

1. Use a screwdriver to remove the 4 screws on the back cover of the remote, allowing you to open it.



2. Remove another 4 screws on the remote's circuit board.



3. Lift the circuit board and slide out the battery, as shown below.

Note: Avoid rotating the circuit board to prevent reversing the remote control buttons.

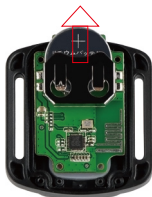

4. Install the new battery, keeping the "+" pole facing up.
5. Install all 4 screws back onto the circuit board.



6. Install all 4 screws back into the cover.

Mounting Your Camera

Enhance your user experience by mounting the camera to various gear like helmets and more. Here's a quick guide.

Note: Before using the camera in any water-related activities, install it onto the waterproof housing to prevent it from getting soaked.





Contact Us

☎ (888) 466-9222 (US) ✉ cs@akasotech.com 🌐 www.akasotech.com

For any inquiries about AKASO products, please feel free to contact us.
We will respond within 24 hours.

